

FLANGE PURLIN ASSEMBLIES

Product Data Sheet

Bremick Flange Purlin Assemblies combine:

- a. Property Class 4.6 Flange Bolt and a Class 5 Flange Nut.
- b. Property Class 8.8 Flange Bolt and a Class 8 Flange Nut.

They are available in both Zinc Plating (ZP) and Hot Dip Galvanised (HDG).

Dimensions are compliant with ISO 4161

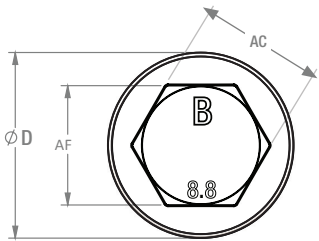
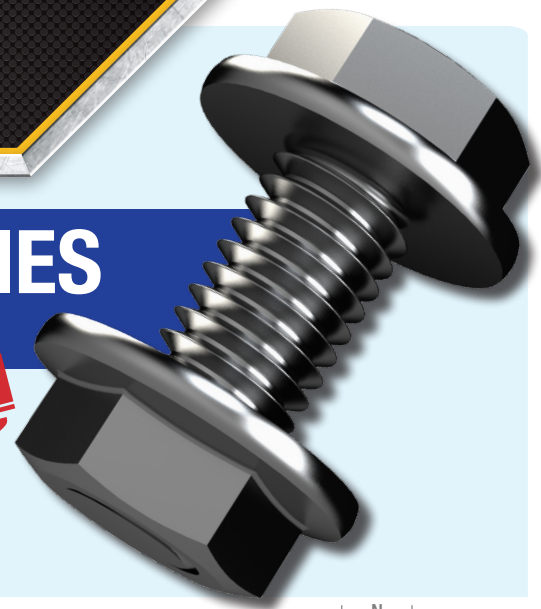

Flange Bolt

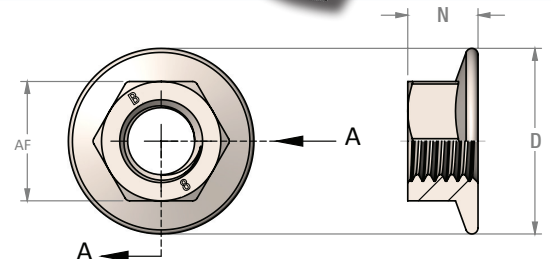
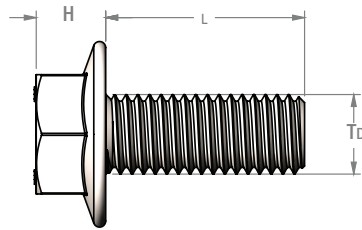

Flange Nut

BREMICK FLANGE PURLIN ASSEMBLY RANGE

| Product Code | Coating | Thread Diameter | Bolt/Nut | | | Bolt | | Nut | Indicative Tightening Torque ¹ | Bolt Tension ² |
|--------------------------------------|---------|-----------------|--------------|----------------|-----------------|-------------|-------------|------------|---|---------------------------|
| | | | Across Flats | Across Corners | Flange Diameter | Bolt Length | Bolt Height | Nut Height | | |
| | | | AF (mm) | AC | ØD (mm) | L (mm) | H (mm) | N (mm) | | |
| Property Class 4.6 Flange Purlins | | | | | | | | | | |
| BFPMG120301 | HDG | M12 | 18 | 20 | 28 | 30 | 10.5 | 12.5 | 28 | 9.50 |
| BFPMG160451 | HDG | M16 | 24 | 26.8 | 32 | 45 | 13.5 | 17.5 | 62 | 17.65 |
| BFPMZ120301 | ZP | M12 | 18 | 20 | 28 | 30 | 10.5 | 12.5 | 28 | 9.50 |
| BFPMZ120551 | ZP | M12 | 18 | 20 | 28 | 55 | 10.5 | 12.5 | 25 | 9.50 |
| BFPMZ160301 | ZP | M16 | 24 | 26.8 | 32 | 30 | 13.5 | 17.5 | 62 | 17.65 |
| BFPMZ160351 | ZP | M16 | 24 | 20 | 32 | 35 | 13.5 | 17.5 | 62 | 17.65 |
| Property Class 8.8 Flange Purlins | | | | | | | | | | |
| BF8MG120301 | HDG | M12 | 18 | 20 | 28 | 30 | 10.5 | 12.5 | 28 | 24.45 |
| BF8MG160351 | HDG | M16 | 24 | 26.8 | 32 | 35 | 13.5 | 17.5 | 62 | 45.50 |
| BF8MZ120301 | ZP | M12 | 18 | 20 | 28 | 30 | 10.5 | 12.5 | 28 | 24.45 |
| BF8MZ160301 | ZP | M16 | 24 | 26.8 | 32 | 30 | 13.5 | 17.5 | 62 | 45.50 |
| BF8MZ160351 | ZP | M16 | 24 | 26.8 | 32 | 35 | 13.5 | 17.5 | 62 | 45.50 |
| BF8MZ160451 | ZP | M16 | 24 | 26.8 | 32 | 45 | 13.5 | 17.5 | 62 | 45.50 |
| Property Class 4.6 Fascia Assemblies | | | | | | | | | | |
| BFAMZ120301 | ZP | M12 | 18 | 20 | 28 | 30 | 10.5 | 12.5 | 28 | 9.50 |
| BFAMG120301 | HDG | M12 | 18 | 20 | 28 | 30 | 10.5 | 12.5 | 28 | 9.50 |

Notes:

1. The tightening torque shown above can be used as a guide when there are no specifications from the purlin suppliers or engineers.

2. Bolt tension is calculated as 50% percent of the bolt's proof load.

CONTACT YOUR NEAREST BREMICK BRANCH – bremick.com.au – bremick.co.nz

Sydney **02 8332 1500**
Newcastle **02 4948 0504**

Melbourne **03 8710 7400**
Adelaide **08 8359 6900**

Brisbane **07 3273 9700**
Townsville **07 4728 9070**

Perth **08 9302 5255**
Darwin **08 8997 5800**